

'Z' & 'C' Purlin

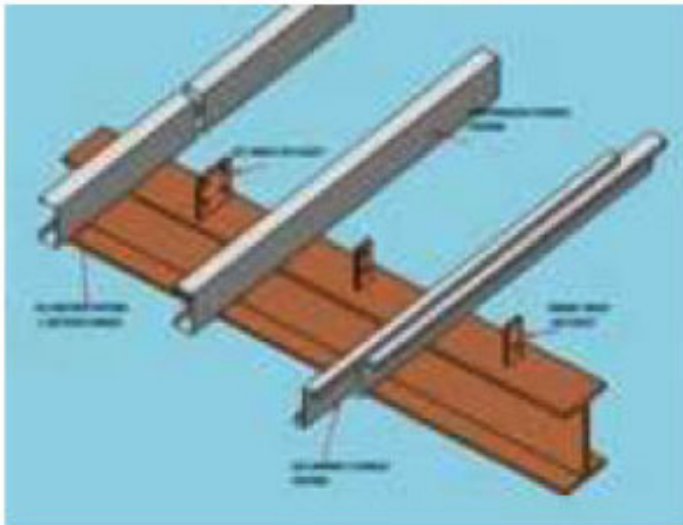

Z section DWG

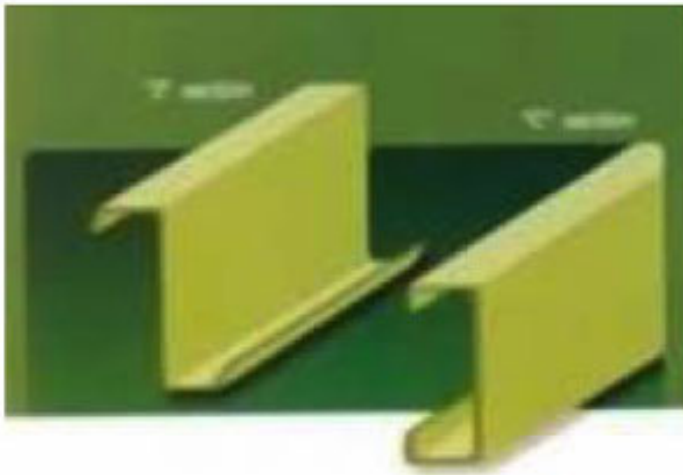
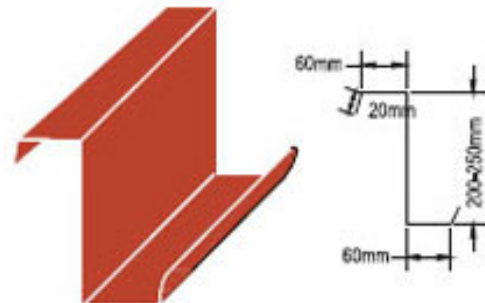

TYPICAL Z- SECTION

Advantage

- Long Purlins reduces no of bays
- Specially cut to length
- Economical, light weight, efficient
- Suitable upto 9 m

Material Specifications

Thickness	: 1.5mm, 1.8mm, 2mm, 2.50mm
Finish	: Mill finish / Galvanised
Steel	: HR - 345 YS, GI - 345 YS

Z CHANNEL SIZE	IXX CM4	IYY CM4	ZXX CM3	ZYY CM3	ACM2	WT/MT IN KG.
200x60x20x1.5	311.24	45.87	31.12	6.25	5.23	4.10
200x60x20x1.8	371.01	54.46	37.10	7.44	6.25	4.90
200x60x20x2	410.40	60.09	41.04	8.22	6.94	5.44
200x60x20x2.5	507.30	73.78	50.73	10.12	8.63	6.83